

Technical data



Available input voltages [Vdc]	12, 24 or 36
Available screw types	Acme
Max. static load at fully retracted [N]	1300
Min. / max. standard stroke [inch]	
S-model	1 / 6
SP-model	2 / 6
Duty cycle @ 25° C [%]	25
Temperature limits at operation [°C]	- 25 to + 65
Protection degree	IP65
Max. end play [mm]	0,9
Restraining torque [Nm]	
S-model	2,3
SP-model	–
Wire cross section [mm ²]	1
Wire length [mm]	100
Connector included	yes

Features for both LA1-S and LA1-SP

- Small
- Weather resistant (IP65)
- Withstand 96 hour salt spray test
- Motor with auto reset thermal overload protection
- Self locking acme screw
- Can operate in a large temperature range
- Accepts large input voltage variations
- Maintenance free
- Models with higher load capacity possible on demand

Features for LA1-S

- End of stroke limit switches
- Six standard strokes

Features for LA1-SP

- Potentiometer feedback
- Anti rotation mechanism
- Three standard strokes

Options

- Custom RAL color

Engineering notes

- No clutch

Performance table

Model	Max. dynamic load [N]	Speed @ min. load [mm/s]	Speed @ max. load [mm/s]
S(P)12-09A04	110	75	52
S(P)24-09A04	110	75	52
S(P)12-09A08	225	45	33
S(P)24-09A08	225	45	33
S(P)12-17A08	340	26	17
S(P)24-17A08	340	26	17
S(P)12-17A16	340	14	7
S(P)24-17A16	340	14	7

Standard strokes

LA1-S ordering stroke	Actual stroke S [mm]
01	21
02	46
03	72
04	97
05	122
06	148

LA1-SP ordering stroke	Actual stroke S [mm]
02	59
04	115
06	171

Dimensions

LA1-S

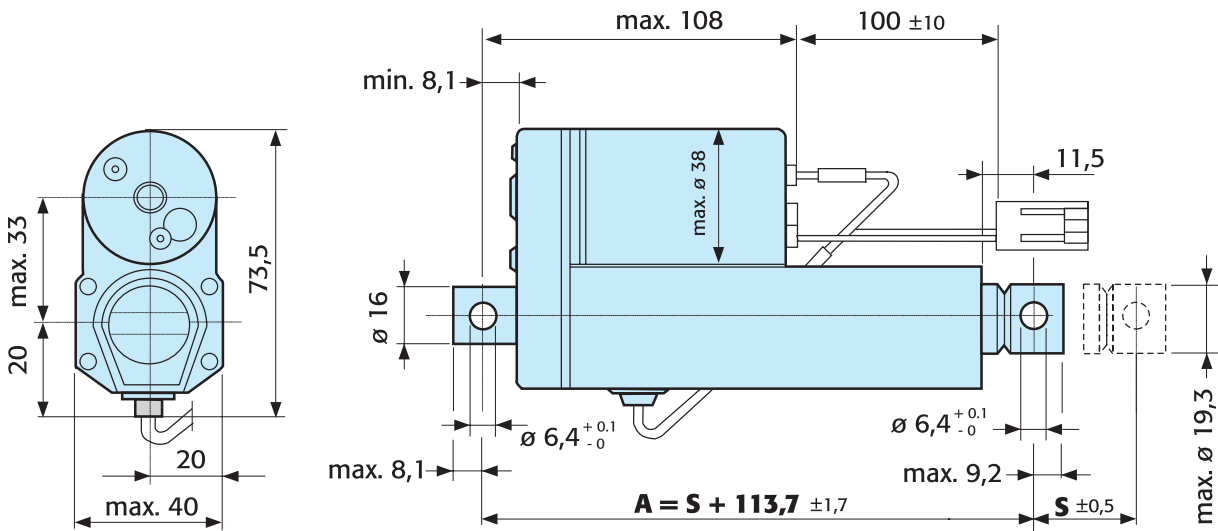

LA-SP

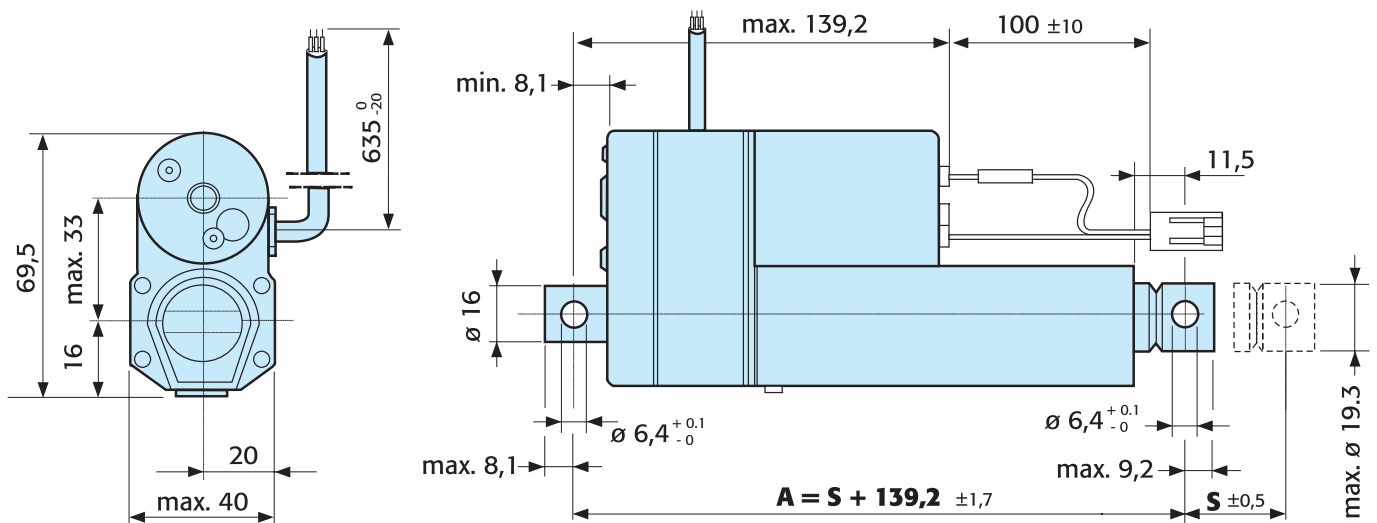

Performance diagrams

